

Dabir Patient Care *Plus*TM System



The Dabir Patient Care *Plus* system is specifically designed to protect patients from developing pressure injuries outside the perioperative care setting.

At the heart of the *Plus* system is the Dabir Controller. Its new compact design with single start button makes it an ergonomic solution for care providers. The easy-to-read color display features therapy status indicators such as surface life and expiration alerts, battery charge level, key lock mode and other menu settings for customized set-up. With its intelligent diagnostic and alert capability, Dabir brings an additional layer of safeguard for patients against pressure injury.

The new Patient Care *Plus* surfaces also bring an enhanced level of performance with new anti-bunching technology, improved patient transfer capability and added securement features. Dabir surfaces are made from medical grade viral barrier materials and printed with easy-to-read instructions.



Dabir Patient Care *Plus*TM System represents the latest innovation in pressure injury prevention technology.

OPTIONAL LITHIUM ION BATTERY ACCESSORY

To protect patients and provide therapy when electrical power is not available, Dabir offers an optional battery-operated controller for accommodating patients during transitions, mobile situations and remote application needs.

Battery Type: Lithium Ion (Medical Grade)

Battery Life: 12 hours (New, Fully Charged)

Recharging Time: 2 hours from lowest charge state

Physical Attributes:

Length: 150 mm (6.0 inches)

Weight: 82 mm (3.2 inches)

Height: 30 mm (1.2 inches)

Useful LCD Indicators:

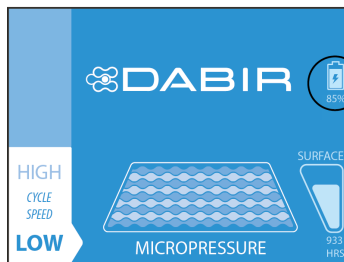

Step 3: Battery Icon Check

- = Connected & Charging
- = Connected & Discharging
- = Battery Life
- = Low Charge (Yellow)
- = Battery Defective

Battery status icons:

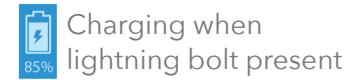
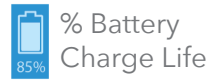

Easy battery removal, test and reinsertion:

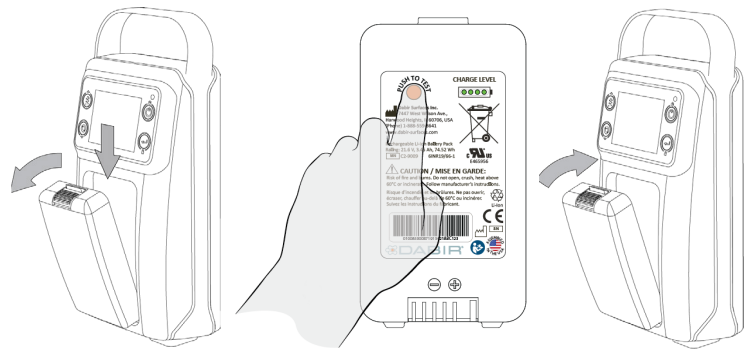

Charge Level



- **Low Battery Alert:** Occurs at 20% remaining charge (approximately 2.5 hours)
- Actual battery life will vary depending on controller settings, age and ambient temperature.
- Battery **SOLD SEPARATELY**

Other Important Information:

- Model Number: C2-9009
- UL Recognized Component in the US and Canada
- CE Compliant / Marked
- Long Term Storage: Always store battery separate from controller.

Technical:

Type: Rechargeable Lithium-Ion

Capacity: 6 cell - Combined Rating at 21.6 Volt (V), 3.45 Amp-hours (Ah), 74.52 Watt-hours (Wh)

See Instructions-for-Use for further details:
www.dabir-surfaces.com/IFU

Made in U.S.A.

Corporate Headquarters:
 Dabir Surfaces, Inc.
 7447 West Wilson Avenue
 Harwood Heights, IL 60706, USA
www.dabir-surfaces.com

Authorized European Representative:
 Emergo Europe,
 Prinsessegracht 20, 2514 AP
 The Hague, The Netherlands

Sales Inquiries:
sales@dabir-surfaces.com
 +1 (888) 559-3641

Technical Support:
support@dabir-surfaces.com
 +1 (888) 559-3642



PATENT:
www.dabir-surfaces.com/patents